



HiLook

Great Performance, Amazing Deals

HiLook

Looking for high performance at a great price? Look at HiLook

HiLook is aimed at providing cost-effective, user-friendly, and reliable performance products for small to medium-sized projects. With a range of network cameras, backend products, video intercoms, and transmission options. With the HiLook app, you can manage your HiLook devices easily on mobile phone. HiLook offers a wide range of solutions for various needs, which have high performance at a reasonable price.

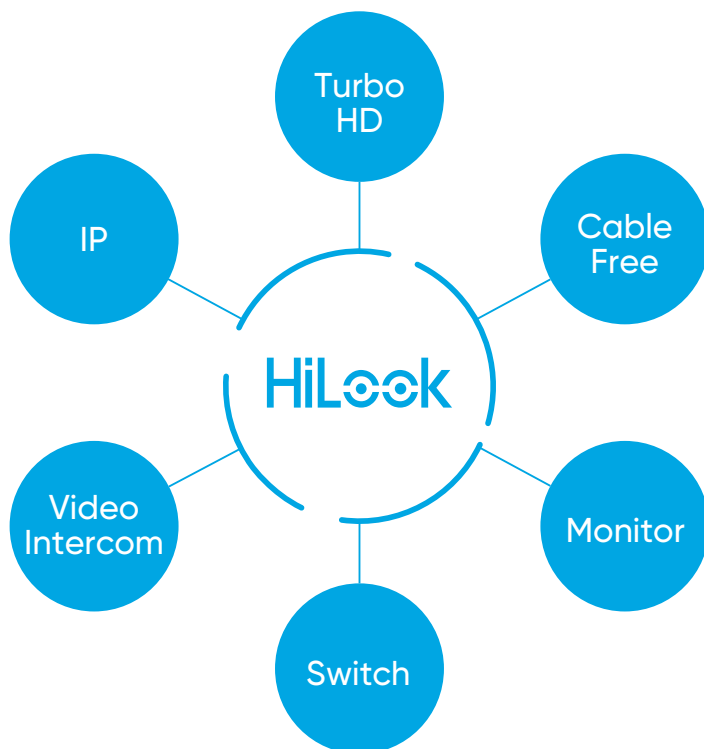

HiLook App

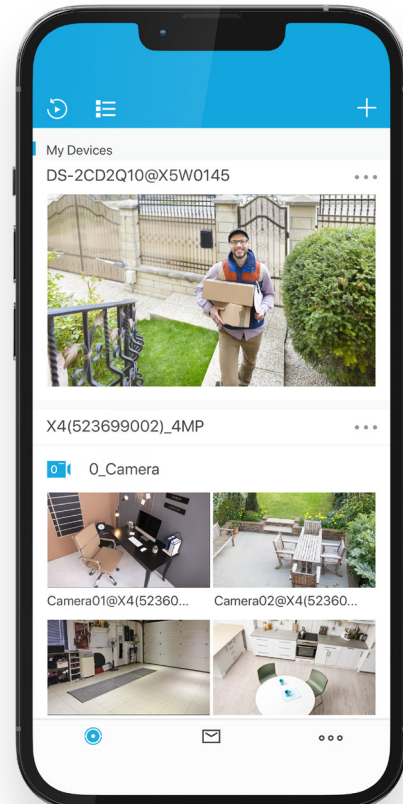

Contents

04 Video Security

- 05 Highlights
- 07 EUI
- 09 Video Security – IP
 - 10 Value Series
 - 16 PT Series
 - 16 PTZ Series
 - 17 Network Video Recorders
 - Value Series NVR
- 19 Video Security – Turbo HD
 - 20 Value Series
 - 23 PTZ Series
 - 24 Backend Products – DVR
- 25 Video Security – Cable Free
- 27 Wi-Fi Cameras
- 27 Video Security – Accessories

28 Video Intercom

- 29 Video Intercom Highlights
- 31 IP Kit
- 31 Hybrid Kit
- 31 4-Wire Kit

32 Switch

- 34 Switch Highlights
- 35 Switch

37 Monitor

- 39 Monitor





Video Security

Video Security – Highlights

ColorVu

The ColorVu technology ensures 24/7 colorful imaging even in dim light conditions, providing a safer night environment, and available at affordable prices.

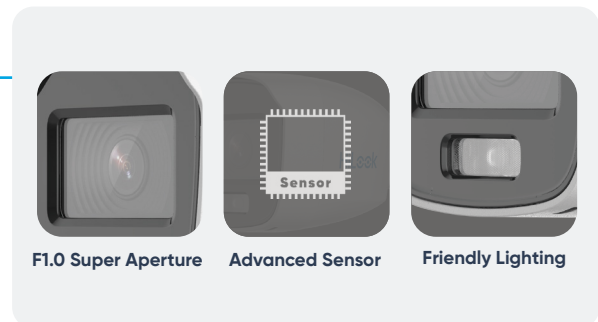

Smart Hybrid Light

HiLook Smart Hybrid Light Cameras offer three supplemental lighting modes: IR, white light, and smart mode. In smart mode, the camera maintains infrared light until the event triggers color imaging.



Motion Detection 2.0

Motion Detection 2.0 enhances detection capabilities with target classification. HiLook products can quickly recognize key objects of persons and vehicles, improving efficiency.



Auto Tracking Lite

Auto Tracking Lite enables the HiLook PT cameras to pan and tilt so that targets are always in the field of view. Stay in frame, stay in focus.



Video Security – Highlights

PT

Easy remote adjustment of any angle via the HiLook app.



Two-way Audio

Two-way audio enables real-time communication, breaking the limits.



Live Guard

Proactive protection with real-time visual and audible warnings.

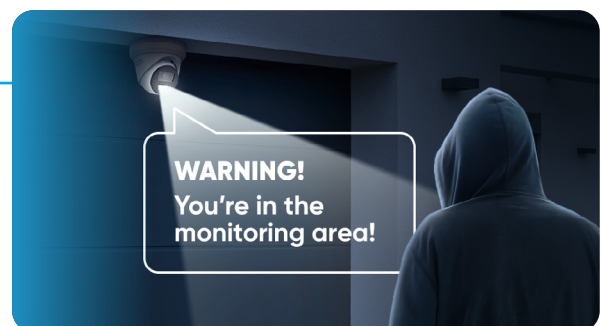

3K Resolution

Ultimate 3K (16:9): Ultimate visual experience without distortion, available for Turbo HD cameras.

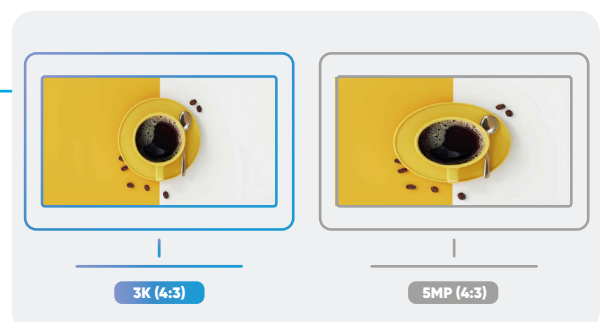

Video Security – EUI

Easy and Efficient User Interface

Simple and concise design with only four necessary models on the dashboard header, making it easier for users.

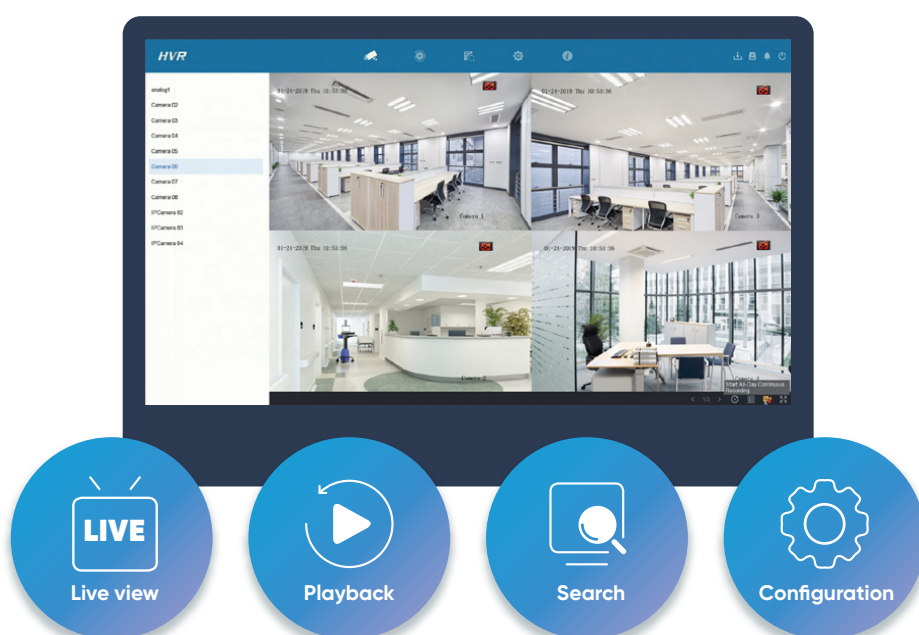

New Startup Wizard

Unlock the new startup wizard for HiLook NVRs and DVRs. It only takes five steps to complete: Select language — Set password — Auto configuration — HiLook app settings — Password recovery method setting, and activation complete!

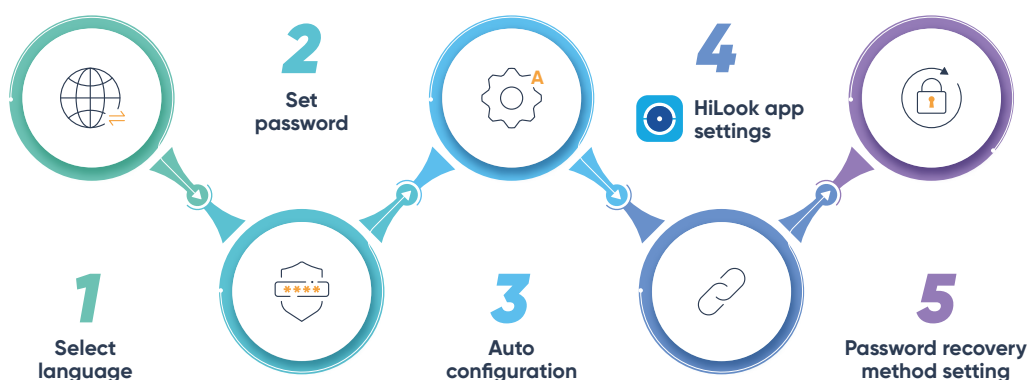

Video Security – EUI

Retrieve & Reset Password in Seconds

Users can reset their HiLook NVR or DVR password using three methods:

1. Using the HiLook app

01

Choose "Verify with HiLook app"



02

Scan the QR code on the GUI and get a verification code

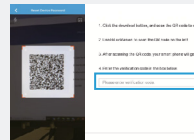

03

Key in the verification code and reset password

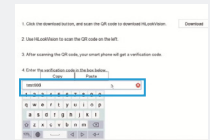

Tips: The HiLook app account needs to be bound with devices in advance, so we highly recommend binding the device to your HiLook app account during activation.

2. Using Email

01

Choose "Verify by Email"

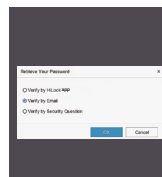

02

Read and accept "Privacy Policy"



03

Key in the verification code and reset password



3. Using password hints

01

Retrieve Your Password

☐ Verify by HiLook app
☐ Verify by Email
☒ Verify by Security Question

02

Please answer the security questions, and click OK to reset password.

1. Your father's name
2. Your mother's name
3. Your favorite color

03

Reset Password

User Name: admin
Create New Password:
Confirm New Password:
Password Hint:



Video Security IP

HiLook IP camera is where innovation meets practicality. With ColorVu technology, you can see vivid colors even in low-light environment. The Smart Hybrid Light features three supplemental lighting modes, providing flexible lighting options. Combined with Motion Detection 2.0 for person and vehicle classification, as well as Two-way Audio for crystal-clear sound effect. The HiLook IP camera offers a comprehensive solution for video security.

With no difficult IP setup and only one cable for power and data, the PoE feature connects cameras and NVRs quickly and easily. The NVRs ensure a smooth live view and fluid playback through reliable video recording and management. HiLook is expertly designed for small business security.



IPC-B429HA-LU

- High quality imaging with 2 MP resolution
- Support Persons and Vehicles Detection
- Smart Hybrid Light: advanced technology with long range
- Built-in microphone for real-time audio security
- Efficient H.265+ compression technology
- Water and dust resistant (IP67)

Accessory Code: **J1**



IPC-B149HA-LU

- High quality imaging with 4 MP resolution
- Support Persons and Vehicles Detection
- Smart Hybrid Light: advanced technology with long range
- Efficient H.265+ compression technology
- Built-in microphone for real-time audio security
- Water and dust resistant (IP67)

Accessory Code: **J1**



IPC-B169HA-LU

- High quality imaging with 6 MP resolution
- Support Persons and Vehicles Detection
- Smart Hybrid Light: advanced technology with long range
- Efficient H.265+ compression technology
- Built-in microphone for real-time audio security
- Water and dust resistant (IP67)

Accessory Code: **J1**



IPC-B469HA-LU

- High quality imaging with 6 MP resolution
- Support Persons and Vehicles Detection
- Smart Hybrid Light: advanced technology with long range
- Efficient H.265+ compression technology
- Built-in microphone for real-time audio security
- Water and dust resistant (IP67)

Accessory Code: **J1**



IPC-B129HA-LU

- High quality imaging with 2 MP resolution
- Support Persons and Vehicles Detection
- Smart Hybrid Light: advanced technology with long range
- Efficient H.265+ compression technology
- Built-in microphone for real-time audio security
- Water and dust resistant (IP67)

Accessory Code: **J1**



IPC-T229HA-LU

- High quality imaging with 2 MP resolution
- Support Persons and Vehicles Detection
- Smart Hybrid Light: advanced technology with long range
- Built-in microphone for real-time audio security
- Efficient H.265+ compression technology
- Water and dust resistant (IP67)

Accessory Code: **J2 W1**



IPC-B449HA-LU

- High quality imaging with 4 MP resolution
- Support Persons and Vehicles Detection
- Smart Hybrid Light: advanced technology with long range
- Efficient H.265+ compression technology
- Built-in microphone for real-time audio security
- Water and dust resistant (IP67)

Accessory Code: **J1**



IPC-D129HA-LU

- High quality imaging with 2 MP resolution
- Support Persons and Vehicles Detection
- Smart Hybrid Light: advanced technology with long range
- Built-in microphone for real-time audio security
- Efficient H.265+ compression technology
- Water and dust resistant (IP67) and vandal resistant (IK08)

Accessory Code: **J6 W2**



IPC-D149HA-LU

- High quality imaging with 4 MP resolution
- Support Persons and Vehicles Detection
- Smart Hybrid Light: advanced technology with long range
- Efficient H.265+ compression technology
- Built-in microphone for real-time audio security
- Water and dust resistant (IP67) and vandal resistant (IK08)

Accessory Code: **J6 W2**



IPC-T249HA-LU

- High quality imaging with 4 MP resolution
- Support Persons and Vehicles Detection
- Smart Hybrid Light: advanced technology with long range
- Built-in microphone for real-time audio security
- Water and dust resistant (IP67)
- Efficient H.265+ compression technology

Accessory Code: **J2** **W1**



IPC-D169HA-LU

- High quality imaging with 6 MP resolution
- Support Persons and Vehicles Detection
- Smart Hybrid Light: advanced technology with long range
- Built-in microphone for real-time audio security
- Efficient H.265+ compression technology
- Water and dust resistant (IP67) and vandal resistant (IK08)

Accessory Code: **J6** **W2**



IPC-B620HA-LZU

- High quality imaging with 2 MP resolution
- Support Persons and Vehicles Detection
- Smart Hybrid Light: advanced technology with long range
- Clear imaging against strong back light due to DWDR technology
- Efficient H.265+ compression technology
- Support on-board storage up to 512 GB (SD card slot)
- Built-in microphone for real-time audio security
- 2.8 to 12 mm motorized varifocal lens for easy installation and monitoring
- Water and dust resistant (IP67)

Accessory Code: **J2**



IPC-D640HA-LZU

- High quality imaging with 4 MP resolution
- Support Persons and Vehicles Detection
- Smart Hybrid Light: advanced technology with long range
- Clear imaging against strong back light due to 120 dB true WDR technology
- Efficient H.265+ compression technology
- Support on-board storage up to 512 GB (SD card slot)
- Built-in microphone for real-time audio security
- 2.8 to 12 mm motorized varifocal lens for easy installation and monitoring
- Water and dust resistant (IP67) and vandal proof (IK08)

Accessory Code: **J6** **W2**



IPC-B640HA-LZU

- High quality imaging with 4 MP resolution
- Support Persons and Vehicles Detection
- Smart Hybrid Light: advanced technology with long range
- Clear imaging against strong back light due to 120 dB true WDR technology
- 2.8 to 12 mm motorized varifocal lens for easy installation and monitoring
- Support on-board storage up to 512 GB (SD card slot)
- Efficient H.265+ compression technology
- Water and dust resistant (IP67)
- Built-in microphone for real-time audio security

Accessory Code: **J2**



IPC-D620HA-LZU

- High quality imaging with 2 MP resolution
- Support Persons and Vehicles Detection
- Smart Hybrid Light: advanced technology with long range
- Clear imaging against strong back light due to DWDR technology
- Efficient H.265+ compression technology
- Support on-board storage up to 512 GB (SD card slot)
- Built-in microphone for real-time audio security
- 2.8 to 12 mm motorized varifocal lens for easy installation and monitoring
- Water and dust resistant (IP67) and vandal proof (IK08)

Accessory Code: **J6** **W2**



IPC-D140HA-LU

- High quality imaging with 4 MP resolution
- Support Persons and Vehicles Detection
- Smart Hybrid Light: advanced technology with long range
- Built-in microphone for real-time audio security
- Water and dust resistant (IP67) and vandal resistant (IK08)
- Efficient H.265+ compression technology

Accessory Code:



IPC-B140HA-LU

- High quality imaging with 4 MP resolution
- Support Persons and Vehicles Detection
- Smart Hybrid Light: advanced technology with long range
- Built-in microphone for real-time audio security
- Water and dust resistant (IP67)
- Efficient H.265+ compression technology

Accessory Code:



IPC-D120HA-LU

- High quality imaging with 2 MP resolution
- Support Persons and Vehicles Detection
- Smart Hybrid Light: advanced technology with long range
- Built-in microphone for real-time audio security
- Water and dust resistant (IP67) and vandal resistant (IK08)
- Efficient H.265+ compression technology

Accessory Code:



IPC-B120HA-LU

- High quality imaging with 2 MP resolution
- Support Persons and Vehicles Detection
- Smart Hybrid Light: advanced technology with long range
- Built-in microphone for real-time audio security
- Water and dust resistant (IP67)
- Efficient H.265+ compression technology

Accessory Code:



IPC-B440HA-LU

- High quality imaging with 4 MP resolution
- Support Persons and Vehicles Detection
- Smart Hybrid Light: advanced technology with long range
- Built-in microphone for real-time audio security
- Water and dust resistant (IP67)
- Efficient H.265+ compression technology

Accessory Code:



IPC-T240HA-LU

- High quality imaging with 4 MP resolution
- Support Persons and Vehicles Detection
- Smart Hybrid Light: advanced technology with long range
- Built-in microphone for real-time audio security
- Water and dust resistant (IP67)
- Efficient H.265+ compression technology

Accessory Code:



IPC-T220HA-LU

- High quality imaging with 2 MP resolution
- Support Persons and Vehicles Detection
- Smart Hybrid Light: advanced technology with long range
- Built-in microphone for real-time audio security
- Water and dust resistant (IP67)
- Efficient H.265+ compression technology

Accessory Code:



IPC-B420HA-LU

- High quality imaging with 2 MP resolution
- Support Persons and Vehicles Detection
- Smart Hybrid Light: advanced technology with long range
- Built-in microphone for real-time audio security
- Water and dust resistant (IP67)
- Efficient H.265+ compression technology

Accessory Code:



IPC-B620HA-Z

- High quality imaging with 2 MP resolution
- Support Persons and Vehicles Detection
- 2.8 to 12 mm motorized varifocal lens for easy installation and monitoring
- Up to 256 GB SD card slot for storage
- Water and dust resistant (IP67)
- EXIR 2.0: advanced infrared technology with long IR range
- Clear imaging even with strong back lighting due to DWDR technology
- Efficient H.265+ compression technology

Accessory Code:





IPC-B640HA-Z

- High quality imaging with 4 MP resolution
- Support Persons and Vehicles Detection
- 2.8 to 12 mm motorized varifocal lens for easy installation and monitoring
- Up to 256 GB SD card slot for storage
- Water and dust resistant (IP67)
- EXIR 2.0: advanced infrared technology with long IR range
- Clear imaging even with strong back lighting due to 120 dB WDR technology
- Efficient H.265+ compression technology

Accessory Code: **J2**



IPC-T620HA-Z

- High quality imaging with 2 MP resolution
- Support Persons and Vehicles Detection
- 2.8 to 12 mm motorized varifocal lens for easy installation and monitoring
- Up to 256 GB memory card slot for storage
- Water and dust resistant (IP67)
- EXIR 2.0: advanced infrared technology with long IR range
- Clear imaging even with strong back lighting due to DWDR technology
- Efficient H.265+ compression technology

Accessory Code: **J3 W5**



IPC-T640HA-Z

- High quality imaging with 4 MP resolution
- Support Persons and Vehicles Detection
- 2.8 to 12 mm motorized varifocal lens for easy installation and monitoring
- Up to 256 GB SD card slot for storage
- Water and dust resistant (IP67)
- EXIR 2.0: advanced infrared technology with long IR range
- Clear imaging even with strong back lighting due to 120 dB WDR technology
- Efficient H.265+ compression technology

Accessory Code: **J3 W5**



IPC-D620HA-Z

- High quality imaging with 2 MP resolution
- Support Persons and Vehicles Detection
- 2.8 to 12 mm motorized varifocal lens for easy installation and monitoring
- Up to 256 GB SD card slot for storage
- Water and dust resistant (IP67), vandal proof (IK10)
- EXIR 2.0: advanced infrared technology with long IR range
- Clear imaging even with strong back lighting due to DWDR technology
- Efficient H.265+ compression technology

Accessory Code: **J5 W3**



IPC-D640HA-Z

- High quality imaging with 4 MP resolution
- Support Persons and Vehicles Detection
- 2.8 to 12 mm motorized varifocal lens for easy installation and monitoring
- Up to 256 GB SD card slot for storage
- Water and dust resistant (IP67) and vandal proof (IK10)
- EXIR 2.0: advanced infrared technology with long IR range
- Clear imaging even with strong back lighting due to 120 dB WDR technology
- Efficient H.265+ compression technology

Accessory Code: **J5 W3**



IPC-B420HA

- High quality imaging with 2 MP resolution
- Support Persons and Vehicles Detection
- Water and dust resistant (IP67)
- Efficient H.265+ compression technology to save bandwidth and storage
- Easy installation with Power over Ethernet (PoE) technology

Accessory Code: **J1**



IPC-T220HA

- High quality imaging with 2 MP resolution
- Support Persons and Vehicles Detection
- Water and dust resistant (IP67)
- Efficient H.265+ compression technology to save bandwidth and storage
- Easy installation with Power over Ethernet (PoE) technology

Accessory Code: **J2 W4**



IPC-B120HA

- High quality imaging with 2 MP resolution
- Support Persons and Vehicles Detection
- Water and dust resistant (IP67)
- Efficient H.265+ compression technology to save bandwidth and storage
- Easy installation with Power over Ethernet (PoE) technology

Accessory Code: **J1**



IPC-D120HA

- High quality imaging with 2 MP resolution
- Support Persons and Vehicles Detection
- Water and dust resistant (IP67) and vandal resistant (IK10)
- Efficient H.265+ compression technology to save bandwidth and storage
- Easy installation with Power over Ethernet (PoE) technology

Accessory Code: **J4 W2**



IPC-B440HA

- High quality imaging with 4 MP resolution
- Support Persons and Vehicles Detection
- Water and dust resistant (IP67)
- Clear imaging against strong back light due to 120 dB true WDR technology
- Efficient H.265+ compression technology to save bandwidth and storage
- Easy installation with Power over Ethernet (PoE) technology

Accessory Code: **J1**



IPC-D140HA

- High quality imaging with 4 MP resolution
- Support Persons and Vehicles Detection
- Water and dust resistant (IP67) and vandal resistant (IK10)
- Clear imaging against strong back light due to 120 dB true WDR technology
- Efficient H.265+ compression technology to save bandwidth and storage
- Easy installation with Power over Ethernet (PoE) technology

Accessory Code: **J4 W2**



IPC-T240HA

- High quality imaging with 4 MP resolution
- Support Persons and Vehicles Detection
- Water and dust resistant (IP67)
- Clear imaging even with strong back lighting due to 120 dB WDR
- Efficient H.265+ compression technology
- EXIR 2.0: advanced infrared technology with long IR range

Accessory Code: **J2 W4**



IPC-B140HA

- High quality imaging with 4 MP resolution
- Support Persons and Vehicles Detection
- Water and dust resistant (IP67)
- Clear imaging even with strong back lighting due to 120 dB WDR
- Efficient H.265+ compression technology
- EXIR 2.0: advanced infrared technology with long IR range

Accessory Code: **J1**



IPC-B420H

- High quality imaging with 2 MP resolution
- Clear imaging against strong back light due to DWDR technology
- Efficient H.265+ compression technology
- Water and dust resistant (IP67)
- Easy installation with Power over Ethernet (PoE) technology
- 3D DNR technology delivers clean and sharp images

Accessory Code: **J1**



IPC-B440H

- High quality imaging with 4 MP resolution
- Clear imaging against strong back light due to 120 dB WDR technology
- Efficient H.265+ compression technology
- Water and dust resistant (IP67)
- Easy installation with Power over Ethernet (PoE) technology
- 3D DNR technology delivers clean and sharp images

Accessory Code: **J1**



IPC-B640H-Z

- High quality imaging with 4 MP resolution
- Efficient H.265+ compression technology to save bandwidth and storage
- Clear imaging against strong back light due to 120 dB true WDR technology
- Water and dust resistant (IP67)
- Motorized varifocal lens for easy installation and monitoring

Accessory Code: **J2**



IPC-D640H-Z

- High quality imaging with 4 MP resolution
- Efficient H.265+ compression technology to save bandwidth and storage
- Clear imaging against strong back light due to 120 dB true WDR technology
- Water and dust resistant (IP67) and vandal proof (IK10)
- Motorized varifocal lens for easy installation and monitoring

Accessory Code: **J4 W3**



IPC-T621H-Z

- High quality imaging with 2 MP resolution
- Efficient H.265+ compression technology to save bandwidth and storage
- Clear imaging against strong back light due to DWDR technology
- Water and dust resistant (IP67)
- Motorized varifocal lens for easy installation and monitoring

Accessory Code: **J5 W3**



IPC-T641H-Z

- High quality imaging with 4 MP resolution
- Efficient H.265+ compression technology to save bandwidth and storage
- Clear imaging against strong back light due to 120 dB true WDR technology
- Water and dust resistant (IP67)
- Motorized varifocal lens for easy installation and monitoring

Accessory Code: **J5** **W3**



IPC-D121H

- High quality imaging with 2 MP resolution
- Efficient H.265+ compression technology
- Clear imaging against strong back light due to DWDR technology
- Water and dust resistant (IP67) and vandal proof (IK10)
- Easy installation with power over Ethernet (PoE) technology

Accessory Code: **J4** **W1**



IPC-T221H

- High quality imaging with 2 MP resolution
- Efficient H.265+ compression technology
- Clear imaging against strong back light by DWDR technology
- Water and dust resistant (IP67)
- Easy installation with Power over Ethernet (PoE) technology

Accessory Code: **J2** **W4**



IPC-B121H

- High quality imaging with 2 MP resolution
- Efficient H.265+ compression technology
- Clear imaging against strong back light due to DWDR technology
- Water and dust resistant (IP67)
- EXIR 2.0: advanced infrared technology with long IR range

Accessory Code: **J1**



IPC-B140H

- High quality imaging with 4 MP resolution
- Efficient H.265+ compression technology to save bandwidth and storage
- Clear imaging against strong back light due to 120 dB true WDR technology
- Water and dust resistant (IP67)
- 3D DNR technology delivers clean and sharp images
- Easy installation with Power over Ethernet (PoE) technology

Accessory Code: **J1**



IPC-T240H

- High quality imaging with 4 MP resolution
- Efficient H.265+ compression technology to save bandwidth and storage
- Clear imaging against strong back light due to 120 dB true WDR technology
- Water and dust resistant (IP67)
- 3D DNR technology delivers clean and sharp images
- Easy installation with Power over Ethernet (PoE) technology

Accessory Code: **J2** **W4**



IPC-D140H

- High quality imaging with 4 MP resolution
- Efficient H.265+ compression technology to save bandwidth and storage
- Clear imaging against strong back light due to 120 dB true WDR technology
- Water and dust resistant (IP67) and vandal resistant (IK10)
- 3D DNR technology delivers clean and sharp images
- Easy installation with Power over Ethernet (PoE) technology

Accessory Code: **J4** **W1**

Video Security - IP — PT Series



PTZ-N2404I-DE3

- 4 MP @ 25/30 fps, 2.8–12 mm lens
- Two-way audio
- Pan: 0° to 355°, tilt: 0° to 90°
- 20 m IR
- Power-over-Ethernet
- IP66, IK10



PTZ-N2C400M-DE

- 4 MP @ 25 fps, 2.8 mm/4 mm lens
- Two-way audio
- Pan: 0° to 345°, tilt: 0° to 80°
- Smart Hybrid Light
- 30 m white light and 30 m IR
- Power-over-Ethernet
- IP66



PTZ-N2D400M-DE/14

- 4 MP+4 MP @ 25 fps, 2.8 mm+6 mm lens
- Two-way audio
- Pan: 0° to 350°, tilt: -5° to 90°
- Smart Hybrid Light
- Static: 30 m white light and 30 m IR; PT: 30 m IR
- Smart Linkage
- Power-over-Ethernet
- IP66



Video Security - IP — PTZ Series



PTZ-N4215-DE3

- 1/2.8" 2 MP CMOS, 15x optical zoom
- 2 MP@25/30 fps
- Pan: 360° endless, tilt: 0° to 90°
- Power-over-Ethernet



PTZ-N4215I-DE

- 1/2.8" 2 MP CMOS, 15x optical zoom
- 2 MP@25/30 fps
- Pan: 360° endless, tilt: -15° to 90°
- 100 m IR
- Power-over-Ethernet
- IP66



PTZ-N4225I-DE

- 1/2.8" 2 MP CMOS, 25x optical zoom
- 2 MP@25/30 fps
- Pan: 360° endless, tilt: -15° to 90°
- 100 m IR
- Power-over-Ethernet
- IP66



PTZ-N5225I-DE

- 1/2.8" 2 MP CMOS, 25x optical zoom
- 2 MP@25/30 fps
- Pan: 360° endless, tilt: -15° to 90°
- 150 m IR
- Power-over-Ethernet
- IP66



NVR-104H-D(D)

4-ch 1-HDD NVR

- Up to 4-ch IP camera inputs
- Incoming/outgoing bandwidth: 40 Mbps/ 60 Mbps
- Up to 1-ch @ 6 MP/4-ch @ 1080p decoding capacity
- 1 SATA interface, up to 6 TB for each HDD
- 1 HDMI, 1 VGA
- Mini 1U case (plastic)



NVR-104H-D/4P(D)

4-ch 1-HDD PoE NVR

- Up to 4-ch IP camera inputs
- Incoming/outgoing bandwidth: 40 Mbps/ 60 Mbps
- Up to 1-ch @ 6 MP/4-ch @ 1080p decoding capacity
- 1 SATA interface, up to 6 TB for each HDD
- 1 HDMI, 1 VGA
- Mini 1U case (plastic)
- /P: PoE



NVR-108H-D(D)

8-ch 1-HDD NVR

- Up to 8-ch IP camera inputs
- Incoming/outgoing bandwidth: 60 Mbps/ 60 Mbps
- Up to 1-ch @ 6 MP/4-ch @ 1080p decoding capacity
- 1 SATA interface, up to 6 TB for each HDD
- 1 HDMI, 1 VGA
- Mini 1U case (plastic)



NVR-108H-D/8P(D)

8-ch 1-HDD PoE NVR

- Up to 8-ch IP camera inputs
- Incoming/outgoing bandwidth: 60 Mbps/ 60 Mbps
- Up to 1-ch @ 6 MP/4-ch @ 1080p decoding capacity
- 1 SATA interface, up to 6 TB for each HDD
- 1 HDMI, 1 VGA
- Mini 1U case (plastic)
- /P: PoE



NVR-104MH-D(D)

4-ch 1-HDD NVR

- Up to 4-ch IP camera inputs
- Incoming/outgoing bandwidth: 40 Mbps/ 60 Mbps
- Up to 1-ch @ 6 MP/4-ch @ 1080p decoding capacity
- 1 SATA interface, up to 6 TB for each HDD
- 1 HDMI, 1 VGA
- 260 1U case (metal)



NVR-104MH-D/4P(D)

4-ch 1-HDD PoE NVR

- Up to 4-ch IP camera inputs
- Incoming/outgoing bandwidth: 40 Mbps/ 60 Mbps
- Up to 1-ch @ 6 MP/4-ch @ 1080p decoding capacity
- 1 SATA interface, up to 6 TB for each HDD
- 1 HDMI, 1 VGA
- 260 1U case (metal)
- /P: PoE



NVR-108MH-D(D)

8-ch 1-HDD NVR

- Up to 8-ch IP camera inputs
- Incoming/outgoing bandwidth: 60 Mbps/ 60 Mbps
- Up to 1-ch @ 6 MP/4-ch @ 1080p decoding capacity
- 1 SATA interface, up to 6 TB for each HDD
- 1 HDMI, 1 VGA
- 260 1U case (metal)



NVR-108MH-D/8P(D)

8-ch 1-HDD PoE NVR

- Up to 8-ch IP camera inputs
- Incoming/outgoing bandwidth: 60 Mbps/ 60 Mbps
- Up to 1-ch @ 6 MP/4-ch @ 1080p decoding capacity
- 1 SATA interface, up to 6 TB for each HDD
- 1 HDMI, 1 VGA
- 260 1U case (metal)
- /P: PoE



NVR-104MH-C(D)

4-ch 1-HDD NVR

- Up to 4-ch IP camera inputs
- Incoming/outgoing bandwidth: 40 Mbps/ 80 Mbps
- Up to 1-ch @ 8 MP/6-ch @ 1080p decoding capacity
- 1 SATA interface, up to 8 TB for each HDD
- 1 HDMI, 1 VGA
- 260 1U case (metal)
- Up to 1-ch Motion Detection 2.0



NVR-104MH-C/4P(D)

4-ch 1-HDD PoE NVR

- Up to 4-ch IP camera inputs
- Incoming/outgoing bandwidth: 40 Mbps/ 80 Mbps
- Up to 1-ch @ 8 MP/4-ch @ 1080p decoding capacity
- 1 SATA interface, up to 8 TB for each HDD
- 1 HDMI, 1 VGA
- 260 1U case (metal)
- /P: PoE
- Up to 1-ch Motion Detection 2.0



NVR-108MH-C(D)

8-ch 1-HDD NVR

- Up to 8-ch IP camera inputs
- Incoming/outgoing bandwidth: 80 Mbps/ 80 Mbps
- Up to 1-ch @ 8 MP/6-ch @ 1080p decoding capacity
- 1 SATA interface, up to 8 TB for each HDD
- 1 HDMI, 1 VGA
- 260 1U case (metal)
- Up to 4-ch Motion Detection 2.0



NVR-108MH-C/8P(D)

8-ch 1-HDD PoE NVR

- Up to 8-ch IP camera inputs
- Incoming/outgoing bandwidth: 80 Mbps/ 80 Mbps
- Up to 1-ch @ 8 MP/6-ch @ 1080p decoding capacity
- 1 SATA interface, up to 8 TB for each HDD
- 1 HDMI, 1 VGA
- 260 1U case (metal)
- /P: PoE
- Up to 4-ch Motion Detection 2.0



NVR-116MH-C(D)

16-ch 1-HDD NVR

- Up to 16-ch IP camera inputs
- Incoming/outgoing bandwidth: 160 Mbps /80 Mbps
- Up to 1-ch @ 8 MP/6-ch @ 1080p decoding capacity
- 1 SATA interface, up to 8 TB for each HDD
- 1 HDMI, 1 VGA
- 260 1U case (metal)
- Up to 4-ch Motion Detection 2.0



NVR-208MH-C(D)

8-ch 2-HDD NVR

- Up to 8-ch IP camera inputs
- Incoming/outgoing bandwidth: 80 Mbps/ 80 Mbps
- Up to 1-ch @ 8 MP/6-ch @ 1080p decoding capacity
- 2 SATA interface, up to 8 TB for each HDD
- 1 HDMI, 1 VGA
- 380 1U case (metal)
- Up to 4-ch Motion Detection 2.0



NVR-208MH-C/8P(D)

8-ch 2-HDD PoE NVR

- Up to 8-ch IP camera inputs
- Incoming/outgoing bandwidth: 80 Mbps/ 80 Mbps
- Up to 1-ch @ 8 MP/6-ch @ 1080p decoding capacity
- 2 SATA interface, up to 8 TB for each HDD
- 1 HDMI, 1 VGA
- 380 1U case (metal)
- /P: PoE
- Up to 4-ch Motion Detection 2.0



NVR-216MH-C(D)

16-ch 2-HDD NVR

- Up to 16-ch IP camera inputs
- Incoming/outgoing bandwidth: 160 Mbps /80 Mbps
- Up to 1-ch @ 8 MP/6-ch @ 1080p decoding capacity
- 2 SATA interface, up to 8 TB for each HDD
- 1 HDMI, 1 VGA
- 380 1U case (metal)
- Up to 4-ch Motion Detection 2.0



NVR-216MH-C/16P(D)

16-ch 2-HDD PoE NVR

- Up to 16-ch IP camera inputs
- Incoming/outgoing bandwidth: 160 Mbps /80 Mbps
- Up to 1-ch @ 8 MP/6-ch @ 1080p decoding capacity
- 2 SATA interface, up to 8 TB for each HDD
- 1 HDMI, 1 VGA
- 380 1U case (metal)
- /P: PoE
- Up to 4-ch Motion Detection 2.0



Video Security Turbo HD

HiLook's Turbo HD cameras feature plug-and-play capabilities using coaxial cables, and rendering superior imaging in as little light as 0.005 lux. The new Turbo HD Camera features two-way audio for crystal-clear sound effects, a pioneer in the video security industry.

Based on deep learning technology, our DVRs can identify and extract human and vehicle targets and generate high-precision alarms. Users can quickly search video footage based on the appearances of persons or vehicles during a specific period of time.



THC-B120-P(B)

- 2.8/3.6 mm fixed lens
- IP66
- Plastic
- 2 MP CMOS Sensor, 20 m IR, Outdoor EXIR Bullet, ICR

Accessory Code: **J1**



THC-B120-M

- 2.8/3.6 mm fixed lens
- IP66
- Full Metal
- 2 MP CMOS Sensor, 20 m IR, Outdoor EXIR Bullet, ICR

Accessory Code: **J1**



THC-B220-M

- 2.8/3.6/6 mm fixed lens
- IP66
- Full Metal
- 2 MP CMOS Sensor, 40 m IR, Outdoor EXIR Bullet, ICR

Accessory Code: **J1**



THC-T120-P

- 2.8/3.6 mm fixed lens
- Indoor
- Plastic
- 2 MP CMOS Sensor, Indoor EXIR Turret, 20 m IR, ICR

Accessory Code: **J1 W4**



THC-T120-M

- 2.8/3.6 mm fixed lens
- IP66
- Full Metal
- 2 MP CMOS Sensor, 20 m IR, Outdoor EXIR Turret, ICR

Accessory Code: **J1 W4**



THC-T220-M

- 2.8/3.6 mm fixed lens
- IP66
- Full Metal
- 2 MP CMOS Sensor, 40 m IR, Outdoor EXIR Turret, ICR

Accessory Code: **J3 W5**



THC-B320-VF

- 2.8-12 mm Vari Focal Lens
- IP66
- Front cover: Metal
- Main body: Plastic
- Bracket: Metal
- 2 MP CMOS Sensor, 40 m IR, Outdoor EXIR Bullet, ICR

Accessory Code: **J2**



THC-T320-VF

- 2.8-12 mm Vari Focal Lens
- IP66
- Cover & Base: Plastic
- Turret: Metal
- 2 MP CMOS Sensor, 40 m IR, EXIR Turret, ICR

Accessory Code: **J3 W5**



THC-B120-PS

- 2.8/3.6 mm fixed lens
- IP66
- Plastic
- Built-in microphone
- 2 MP CMOS Sensor, 25 m IR, Outdoor EXIR Bullet, ICR

Accessory Code: **J1**



THC-B120-MS

- 2.8/3.6 mm fixed lens
- IP66
- Full Metal
- Built-in microphone
- 2 MP CMOS Sensor, 30 m IR, Outdoor EXIR Bullet, ICR

Accessory Code: **J1**



THC-T120-PS

- 2.8/3.6 mm fixed lens
- Indoor
- Plastic
- Built-in microphone
- 2 MP CMOS Sensor, Indoor EXIR Turret, 20m IR, ICR

Accessory Code: **J1 W4**



THC-T120-MS

- 2.8/3.6 mm fixed lens
- IP66
- Full Metal
- Built-in microphone
- 2 MP CMOS Sensor, 30 m IR, Outdoor EXIR Turret, ICR

Accessory Code: **J1 W4**



THC-T220-MS

- 2.8/3.6 mm fixed lens
- IP66
- Full Metal
- Built-in microphone
- 2 MP CMOS Sensor, 40 m IR, Outdoor EXIR Turret, ICR

Accessory Code:



THC-B127-LPS

- 2.8/3.6 mm fixed lens
- IP66
- Plastic
- Built-in microphone
- 2 MP CMOS Sensor, 20 m White light+20M IR Outdoor white light Bullet

Accessory Code:



THC-B127-LMS

- 2.8/3.6 mm fixed lens
- IP66
- Full Metal
- Built-in microphone
- 2 MP CMOS Sensor, 20 m white light+20M IR Outdoor Smart Hybrid Light Bullet

Accessory Code:



THC-B227-LMS

- 2.8/3.6 mm fixed lens
- IP66
- Full Metal
- Built-in microphone
- 2 MP CMOS Sensor, 20 m white light+40M IR Outdoor Smart Hybrid Light Bullet

Accessory Code:



THC-T127-LPS

- 2.8/3.6 mm fixed lens
- Indoor
- Plastic
- Built-in microphone
- 2 MP CMOS Sensor, Indoor Smart Hybrid Light Turret, 20 m White light+20M IR

Accessory Code:



THC-T127-LMS

- 2.8/3.6 mm fixed lens
- IP66
- Full Metal
- Built-in microphone
- 2 MP CMOS Sensor, 20 m white light+20M IR Outdoor Smart Hybrid Light Turret

Accessory Code:



THC-T227-LMS

- 2.8/3.6 mm fixed lens
- IP66
- Full Metal
- Built-in microphone
- 2 MP CMOS Sensor, 20 m white light+20M IR Outdoor Smart Hybrid Light Turret

Accessory Code:



THC-B129-M

- 2.8/3.6 mm fixed lens
- IP66
- Full Metal
- 2 MP CMOS Sensor, Outdoor Bullet, 0.001Lux/F1.0, 0 Lux with white light, 20 m

Accessory Code:



THC-B229-M

- 2.8/3.6 mm fixed lens
- IP66
- Full Metal
- 2 MP CMOS Sensor, Outdoor Bullet, 0.001Lux/F1.0, 0 Lux with white light, 40 m

Accessory Code:



THC-T129-M

- 2.8/3.6 mm fixed lens
- IP66
- Full Metal
- 2 MP CMOS Sensor, Outdoor Turret, 0.001Lux/F1.0, 0 Lux with white light, 20 m

Accessory Code:



THC-T229-M

- 2.8/3.6 mm fixed lens
- IP66
- Full Metal
- 2 MP CMOS Sensor, Outdoor Turret, 0.001Lux/F1.0, 0 Lux with white light, 40 m

Accessory Code:



THC-B150-P

- 2.8/3.6 mm fixed lens
- IP66
- Plastic
- 5 MP CMOS Sensor, EXIR Bullet, 20 m IR, ICR

Accessory Code:





THC-B150-M

- 2.8/3.6 mm fixed lens
- IP66
- Full Metal
- 5 MP CMOS Sensor, EXIR Bullet, 20 m IR, ICR

Accessory Code: **J1**



THC-T150-P

- 2.8/3.6 mm fixed lens
- Indoor
- Plastic
- 5 MP CMOS Sensor, Indoor EXIR Turret, 20 m IR, ICR

Accessory Code: **J1 W4**



THC-T150-M

- 2.8/3.6 mm fixed lens
- IP66
- Full Metal
- 5 MP CMOS Sensor, EXIR Turret, 20 m IR, ICR

Accessory Code: **J1 W4**



THC-B157-LPS

- 2.8/3.6 mm fixed lens
- IP66
- Plastic
- Built-in microphone
- 3 K CMOS Sensor, 20 m white light+20M IR Outdoor white light Bullet

Accessory Code: **J1**



THC-B157-LMS

- 2.8/3.6 mm fixed lens
- IP66
- Full Metal
- Built-in microphone
- 3 K CMOS Sensor, 20 m white light+20M IR Outdoor Smart Hybrid Light Bullet

Accessory Code: **J1**



THC-B257-LMS

- 2.8/3.6/6 mm fixed lens
- IP66
- Full Metal
- Built-in microphone
- 3 K CMOS Sensor, 20 m white light+40M IR Outdoor Smart Hybrid Light Bullet

Accessory Code: **J1**



THC-T157-LPS

- 2.8/3.6 mm fixed lens
- Indoor
- Plastic
- Built-in microphone
- 3 K CMOS Sensor, Indoor Smart Hybrid Light Turret, 20 m white light+20M IR

Accessory Code: **J1 W4**



THC-T157-LMS

- 2.8/3.6 mm fixed lens
- IP66
- Full Metal
- Built-in microphone
- 3 K CMOS Sensor, 20 m white light+20M IR Outdoor Smart Hybrid Light Turret

Accessory Code: **J1 W4**



THC-T257-LMS

- 2.8/3.6 mm fixed lens
- IP66
- Full Metal
- Built-in microphone
- 3 K CMOS Sensor, 20 m White light+20M IR Outdoor Smart Hybrid Light Turret

Accessory Code: **J2 W4**



THC-B159-MS

- 2.8/3.6 mm fixed lens
- IP66
- Full Metal
- Built-in microphone
- 3 K (5 MP 16:9) CMOS Sensor, 3 K @ 20 fps (Default), Outdoor Bullet, 0.001Lux/F1.0, 0 Lux with white light, 20 m

Accessory Code: **J1**



THC-T159-MS

- 2.8/3.6 mm fixed lens
- IP66
- Full Metal
- Built-in microphone
- 3 K (5 MP 16:9) CMOS Sensor, 3 K @ 20 fps (Default), Outdoor Turret, 0.001Lux/F1.0, 0 Lux with white light, 20 m

Accessory Code: **J1 W4**



PTZ-T4215-D3

- 1/2.8" 2 MP CMOS, 15x optical zoom
- 2 MP @25/30 fps
- Pan: 360° endless, tilt: -5° to 90°
- TVI/AHD/CVI/CVBS video output



PTZ-T4215I-D

- 1/2.8" 2 MP CMOS, 15x optical zoom
- 2 MP @25/30 fps
- Pan: 360° endless, tilt: -15° to 90°
- 100 m IR
- TVI/AHD/CVI/CVBS video output
- IP66



PTZ-T4225I-D

- 1/2.8" 2 MP CMOS, 25x optical zoom
- 2 MP @25/30 fps
- Pan: 360° endless, tilt: -15° to 90°
- 100 m IR
- TVI/AHD/CVI/CVBS video output
- IP66



PTZ-T5225I-A

- 1/2.8" 2 MP CMOS, 25x optical zoom
- 2 MP @25/30 fps
- Pan: 360° endless, tilt: -15° to 90°
- 150 m IR
- TVI/AHD/CVI/CVBS video output
- IP66



DVR-204Q-M1

4-ch 1-HDD DVR

- 4-ch analog video inputs
- Up to 6-ch IP camera inputs (up to 6 MP)
- Up to 3K/5 MP Lite@12 fps, 1080p@15fps encoding capability
- Audio via coaxial cable
- 1 HDD, up to 10 TB for each HDD
- 260 1U case (Metal)
- Motion Detection 2.0 on all 4 channels



DVR-208Q-M1

8-ch 1-HDD DVR

- 8-ch analog video inputs
- Up to 12-ch IP camera inputs (up to 6 MP)
- Up to 3K/5 MP Lite@12 fps, 1080p@15fps encoding capability
- Audio via coaxial cable
- 1 HDD, up to 10 TB for each HDD
- 260 1U case (metal)
- Motion Detection 2.0 on all 8 channels



DVR-216Q-M1

16-ch 1-HDD DVR

- 16-ch analog video inputs
- Up to 24-ch IP camera inputs (up to 6 MP)
- Up to 3K/5 MP Lite@12 fps, 1080p@15fps encoding capability
- Audio via coaxial cable
- 1 HDD, up to 10 TB for each HDD
- 260 1U case (metal)
- Motion Detection 2.0 on all 16 channels



DVR-216Q-M2

16-ch 2-HDD DVR

- 16-ch analog video inputs
- Up to 24-ch IP camera inputs (up to 6 MP)
- Up to 3K/5 MP Lite@12 fps, 1080p@15fps encoding capability
- Audio via coaxial cable
- 2 HDD, up to 10 TB for each HDD
- 380 1U case (metal)
- Motion Detection 2.0 on all 16 channels



DVR-232Q-M2

32-ch 2-HDD DVR

- 32-ch analog video inputs
- Up to 40-ch IP camera inputs (up to 6 MP)
- Up to 3K/5 MP Lite@12 fps, 1080p@15fps encoding capability
- Audio via coaxial cable
- 2 HDD, up to 10 TB for each HDD
- 380 1U case (metal)
- Motion Detection 2.0 on all 32 channels



DVR-204U-M1

4-ch 1-HDD DVR

- 4-ch analog video inputs
- Up to 8-ch IP camera inputs (up to 8 MP)
- Up to 8 MP@8fps, 3K/5 MP@12 fps encoding capability (8 MP@8 fps is only available for channel 1)
- Audio via coaxial cable
- 1 HDD, up to 10 TB for each HDD
- 260 1U case (metal)
- Motion Detection 2.0 on all 4 channels



DVR-208U-M1

8-ch 1-HDD DVR

- 8-ch analog video inputs
- Up to 16-ch IP camera inputs (up to 8 MP)
- Up to 8 MP@8fps, 3K/5 MP@12 fps encoding capability
- Audio via coaxial cable
- 1 HDD, up to 10 TB for each HDD
- 260 1U case (metal)
- Motion Detection 2.0 on all 8 channels



DVR-216U-M2

16-ch 2-HDD DVR

- 16-ch analog video inputs
- Up to 32-ch IP camera inputs (up to 8 MP)
- Up to 8 MP@8fps, 3K/5 MP@12 fps encoding capability
- Audio via coaxial cable
- 2 HDDs, up to 10 TB for each HDD
- 380 1U case (metal)
- Motion Detection 2.0 on all 16 channels



Video Security Cable Free

HiLook Cable Free Wi-Fi cameras offer flexible, hassle-free installation and quick connection for instant viewing. No network wiring, no IP configuration — users without security experience can easily get started with only a few steps.

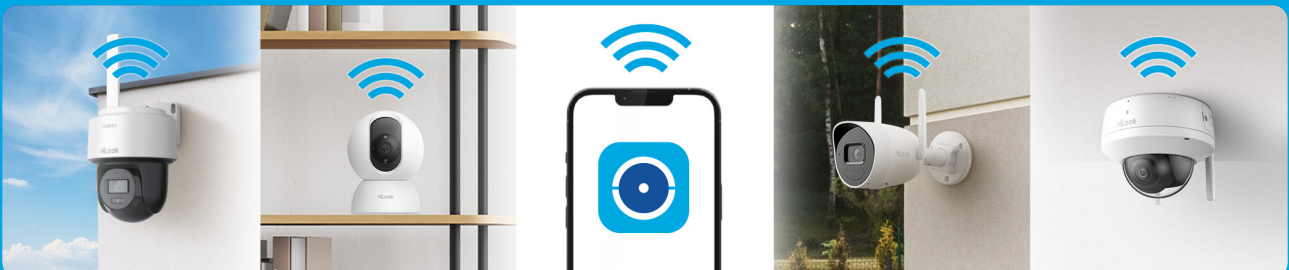



Two-Way Audio

IPC-B120HA-D/W(W)

- High quality image with 2MP resolution
- Supports Persons and Vehicles Detection
- Provide real-time security via built-in two-way audio
- Fixed focal lens, 2.8 and 4 mm optional
- Water and dust resistant (IP66)



Two-Way Audio

IPC-B140HA-D/W(W)

- High quality image with 4MP resolution
- Supports Persons and Vehicles Detection
- Provide real-time security via built-in two-way audio
- Fixed focal lens, 2.8 and 4 mm optional
- Water and dust resistant (IP66)



Two-Way Audio

IPC-D120HA-D/W(W)

- High quality image with 2MP resolution
- Supports Persons and Vehicles Detection
- Provide real-time security via built-in two-way audio
- Fixed focal lens, 2.8 and 4 mm optional
- Water and dust resistant (IP66)



Two-Way Audio

IPC-D140HA-D/W(W)

- High quality image with 4MP resolution
- Supports Persons and Vehicles Detection
- Provide real-time security via built-in two-way audio
- Fixed focal lens, 2.8 and 4 mm optional
- Water and dust resistant (IP66)



Two-Way Audio

IPC-C320HA-D/W(W)

- High quality image with 2MP resolution
- Supports Persons Detection
- Provide real-time security via built-in two-way audio
- Fixed focal lens, 2.8 and 4 mm optional



Two-Way Audio

IPC-C340HA-D/W(W)

- High quality image with 4MP resolution
- Supports Persons Detection
- Provide real-time security via built-in two-way audio
- Fixed focal lens, 2.8 and 4 mm optional



Two-Way Audio

IPC-P220-D/W(W)

- High quality image with 2MP resolution
- Supports Persons Detection
- Provide real-time security via built-in two-way audio
- 4 mm fixed focal lens



Two-Way Audio

PTZ-N2C200I-W(W)

- High quality image with 2MP resolution
- Supports Persons and Vehicles Detection
- Provide real-time security via built-in two-way audio
- Fixed focal lens, 2.8 and 4 mm optional
- Auto Tracking Lite technology
- Water and dust resistant (IP66)







Two-Way Audio

PTZ-N2C400I-W(W)

- High quality image with 4MP resolution
- Supports Persons and Vehicles Detection
- Provide real-time security via built-in two-way audio
- Fixed focal lens, 2.8 and 4 mm optional
- Auto Tracking Lite technology
- Water and dust resistant (IP66)

Video Security Accessories

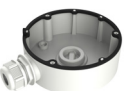
Junction Boxes

Model	Accessory Code
 DS-1280ZJ-XS	J1
 DS-1280ZJ-S	J2
 DS-1280ZJ-M	J3
 DS-1280ZJ-DM18	J4
 DS-1280ZJ-DM21	J5
 DS-1280ZJ-DM46	J6

Wall Mounts

Model	Accessory Code
 DS-1272ZJ-110B	W1
 DS-1272ZJ-120B	W2
 DS-1473ZJ-135B	W3
 DS-1272ZJ-110-TRS	W4
 DS-1273ZJ-130-TRL	W5



Video Intercom



Video Intercom



HD image quality

2 MP camera, offering more details



One-press to call

One-press to call the indoor station via the door station



Remote control

Answer video calls from the door station
Unlock doors remotely from your mobile phone



Plug & play

Easy installation with no additional configuration
for the hybrid kit and 4-wire kit



HiLook App

Front Yard Motion Detection Alarm

Users can always check the camera view of the door station via their mobile app, keeping track of the front door dynamics anytime, anywhere

Video Intercom

HiLook Video Intercom system - Enhance your home security with HiLook's exceptional performance and budget-friendly prices. Our products feature high-definition imaging, easy one-touch calling, real-time video previews, and more to give you peace of mind in your daily life.

Choose from our versatile product range:

IP Kit: IP65 waterproof rating, superior image quality, mobile control support, and user-friendly touch screen interface.

Hybrid Kit: Plug-and-play, high-definition imaging and convenient mobile app support.

4-Wire Kit: Simple plug-and play operation for added user convenience.



Video Intercom — IP Kit



VI-K43P

Door Station: VI-V400W

- 2 MP camera, H:131°, V:78°
- One-press to call
- IR supplement, WDR
- IP65, PoE
- Built-in card reader module
- Convenient app mobile control

Indoor Station: VI-H460W

- 7" touch screen, 1024 x 600
- Wi-Fi
- Convenient mobile control
- 8-ch alarm inputs and 2-ch alarm outputs
- Support voice messages
- Elevator access control



VI-K46P

Door Station: VI-V400W

- 2 MP camera, H:131°, V:78°
- One-press to call
- IR supplement, WDR
- IP65, PoE
- Built-in card reader module
- Convenient app mobile control

Indoor Station: VI-H440W

- 4.3" touch screen, 480 x 272
- Wi-Fi
- Convenient mobile control
- Easy and quick set-up

Protective shield: VI-V400-RS

Video Intercom — Hybrid Kit

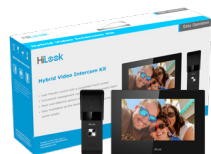

VI-K23P

Door Station: VI-B101

- 2 MP camera
- IR supplement
- One-press to call
- 4-wire plug & play analog interfaces
- IP65, Anti-oxidant aluminium alloy

Indoor Station: VI-H460WD

- 7" touch screen, 1024 x 600
- 2-ch alarm inputs and 2-ch alarm outputs
- TCP/IP, Wi-Fi
- Convenient mobile control
- Support voice messages
- Elevator access control

Video Intercom — 4-Wire Kit



VI-K13P

Door Station: VI-B101

- 2 MP camera
- IR supplement
- One-press to call
- 4-wire plug & play analog interfaces
- IP65, Anti-oxidant aluminium alloy

Indoor Station: VI-H150

- 7" colorful TFT screen, 800 x 480
- 4-wire plug & play analog interfaces
- Supports monitoring door station and external analog cameras



VI-K12P

Door Station: VI-B100

- 2 MP camera
- IR supplement
- One-press to call
- 4-wire plug & play analog interfaces
- IP65, Aluminum Alloy

Indoor Station: VI-H150

- 7" colorful TFT screen, 800 x 480
- 4-wire plug & play analog interfaces
- Supports monitoring door station and external analog cameras



Switch

Switch

HiLook switches offer excellent performance at an affordable price. The switches support Power-over-Ethernet (PoE) and can cover a distance of up to 250 meters. This helps to reduce both network investment and maintenance costs.

Moreover, HiLook switches with 6 KV surge protection prevent sudden high-voltage energy pulses. This feature significantly extends the service life of devices and ensures an uninterrupted power supply to keep IP cameras running smoothly.



Switch Highlights

6 KV Surge Protection

It can protect the switches from high-voltage energy pulses, extending their lifespan.



For common office scenarios, the equipment is deployed indoors and there is less need for surge protection.



Surge Protection

In the field of video security cameras are mostly used outdoors. During thunderstorms, voltage overload or instability can occur.

Long-Distance Transmission

In extended mode, the transmission distance extends up to 250 meters with smooth and stable video streaming, which can save labor and wiring costs.

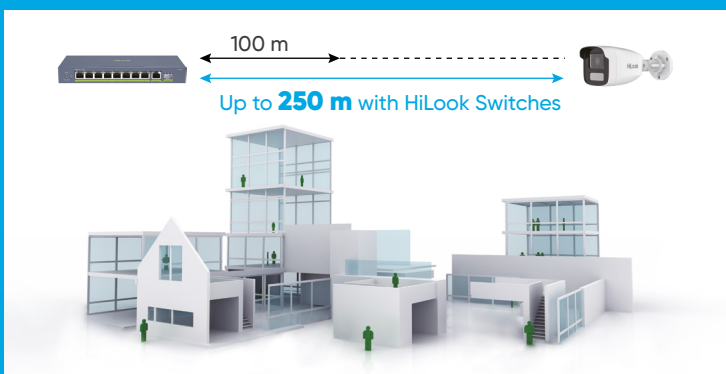

Note:

Meeting the following conditions to achieve long-distance transmission:

- HiLook cameras
- Extend mode
- CAT5e and above network cables



NS-0105D

5 Port Fast Ethernet Unmanaged Desktop Switch

- 5 x 10/100 Mbps ethernet ports
- Support MDI/MDIX
- Store-and-forward switching
- MAC address auto-learning and aging
- Simple and compact body design
- Desktop and wall-mounting installation
- Plug & play, easy to use



NS-0108D

8 Port Fast Ethernet Unmanaged Desktop Switch

- 8 x 10/100 Mbps ethernet ports
- Support MDI/MDIX
- Store-and-forward switching
- MAC address auto-learning and aging
- Simple and compact body design
- Desktop and wall-mounting installation
- Plug & play, easy to use



NS-0505D

5 Port Gigabit Unmanaged Desktop Switch

- 5 x 10/100/1000 Mbps ethernet ports
- Support MDI/MDIX
- Store-and-forward switching
- MAC address auto-learning and aging
- Simple and compact body design
- Desktop and wall-mounting installation
- Plug & play, easy to use



NS-0508D

8 Port Gigabit Unmanaged Desktop Switch

- 8 x 10/100/1000 Mbps ethernet ports
- Supports MDI/MDIX
- Store-and-forward switching
- MAC address auto-learning and aging
- Simple, compact body design
- Desktop and wall-mounting installation
- Plug & play, easy to use



NS-0505

5 Port Gigabit Unmanaged Switch

- 5 x Gigabit RJ45 ports
- 1000 M network access
- Wire-speed forwarding and non-blocking design
- Store-and-forward switching
- Solid high-strength metal shell



NS-0508

8 Port Gigabit Unmanaged Switch

- 8 x Gigabit RJ45 ports
- 1000 M network access
- Wire-speed forwarding and non-blocking design
- Store-and-forward switching
- Solid high-strength metal shell



NS-0516R

16 Port Gigabit Unmanaged Switch

- 16 x 10/100/1000 Mbps RJ45 ports
- Easy plug-and-play installation
- Rack-mounting
- Rugged metal case, exquisite and beautiful design



NS-0524R

24 Port Gigabit Unmanaged Switch

- 24 x 10/100/1000 Mbps RJ45 ports
- Easy plug-and-play installation
- Rack-mounting
- Rugged metal case, exquisite and beautiful design



NS-0105P-35

4 Port Fast Ethernet Unmanaged POE Switch

- 4 x 100 Mbps PoE ports, 1 x 100 Mbps uplink port
- 35 W PoE power budget
- MAC address auto learning and auto aging



NS-0106P-35

4 Port Fast Ethernet Unmanaged PoE Switch

- 4 x 10/100 Mbps PoE ports, 2 x 10/100 Mbps RJ45 ports
- 35 W PoE power budget
- IEEE 802.3, IEEE 802.3u, and IEEE 802.3x standard
- Wire-speed forwarding
- Store-and-forward switching
- Solid high-strength metal shell



NS-0109P-60

8 Port Fast Ethernet Unmanaged PoE Switch

- 8 x 100 Mbps PoE ports, 1 x 100 Mbps RJ45 port
- 60 W PoE power budget
- MAC address auto learning and auto aging



NS-0310P-60

8 Port Fast Ethernet Unmanaged PoE Switch

- 8 x 10/100 Mbps PoE ports, 2 x Gigabit RJ45 ports
- 35 W PoE power budget
- IEEE 802.3, IEEE 802.3u, IEEE 802.3x, IEEE 802.3z and IEEE 802.3ab standard
- Wire-speed forwarding
- Store-and-forward switching
- Solid high-strength metal shell



NS-0318P-130

16 Port Fast Ethernet Unmanaged PoE Switch

- 16 x 100 Mbps PoE ports, 1 x 1000 Mbps RJ45 port, 1 x 1000 Mbps SFP port
- 130 W PoE power budget
- MAC address auto learning and auto aging



NS-0326P-230

24 Port Fast Ethernet Unmanaged PoE Switch

- 24 x 100 Mbps PoE ports, 1 x 1000 Mbps RJ45 port, 1 x 1000 Mbps SFP port
- 230 W PoE power budget
- MAC address auto learning and auto aging



NS-0505P-35

4 Port Gigabit Unmanaged PoE Switch

- 4 x Gigabit PoE ports, 1 x Gigabit RJ45 port
- IEEE 802.3at/af standard
- IEEE 802.3, IEEE 802.3u, IEEE 802.3x, IEEE 802.3ab, and IEEE 802.3z standard
- Wire-speed forwarding and non-blocking design
- Store-and-forward switching
- Solid high-strength metal shell



NS-0510P-58

8 Port Gigabit Unmanaged PoE Switch

- 8 x Gigabit PoE ports, 1 x Gigabit RJ45 port, 1 x Gigabit SFP port
- IEEE 802.3at/af standard
- IEEE 802.3, IEEE 802.3u, IEEE 802.3x, IEEE 802.3ab, and IEEE 802.3z standard
- Wire-speed forwarding and non-blocking design
- Store-and-forward switching
- Solid high-strength metal shell



NS-0518P-125

16 Port Gigabit Unmanaged PoE Switch

- 16 x Gigabit PoE ports, 2 x Gigabit SFP ports
- IEEE 802.3at/af standard
- IEEE 802.3, IEEE 802.3u, and IEEE 802.3x standard
- Wire-speed forwarding
- Store-and-forward switching
- Solid high-strength metal shell



NS-0526P-225

24 Port Gigabit Unmanaged PoE Switch

- 24 x Gigabit PoE ports, 2 x Gigabit SFP ports
- IEEE 802.3at/af standard
- IEEE 802.3, IEEE 802.3u, IEEE 802.3x, IEEE 802.3ab, and IEEE 802.3z standard
- Wire-speed forwarding
- Store-and-forward switching
- Solid high-strength metal shell

A large, stylized graphic of an eye or a monitor screen, composed of concentric semi-circular arcs in shades of blue, centered behind the word "Monitor".

Monitor



Monitor

HiLook monitors have exquisite design, a wider field of view, and superior dual-screen splicing. They also offer full HD imaging to ensure exceptional color with clear details. You can enjoy optimal imaging with the wide, 178-degree viewing angle when you use the monitors.

HiLook monitors comply with VESA mounting standards, and provide multiple interface options. All mainstream interface options are available to meet any need



Hi-D22F2V2F

- 21.45 inch, 1080P, 100HZ
- Interface: HDMI/VGA audio out
- Panel type: VA
- View angle: 178°/178°
- VESA bracket



Hi-D22F2P2F

- 21.45 inch, 1080P, 100HZ
- Interface: HDMI/VGA audio out
- Panel type: IPS
- View angle: 178°/178°
- VESA bracket



Hi-D24F2V2F

- 23.8 inch, 1080P, 100HZ
- Interface: HDMI/VGA audio out
- Panel type: VA
- View angle: 178°/178°
- VESA bracket



Hi-D24F2P2F

- 23.8 inch, 1080P, 100HZ
- Interface: HDMI/VGA audio out
- Panel type: IPS
- View angle: 178°/178°
- VESA bracket

HiLook

Great Performance, Amazing Deals

Disclaimer:

- For detailed product specifications, please refer to the latest datasheet on the official website.
- Please contact your local business representative to learn more about available products.



Search HiLook

